



**TIAME**  
NATIONAL RESEARCH UNIVERSITY



**SUSTAINABLE  
DEVELOPMENT  
GOALS**

**ANNUAL REPORT**  
on the amount of food waste in  
“TIAME” National Research University  
during 2023

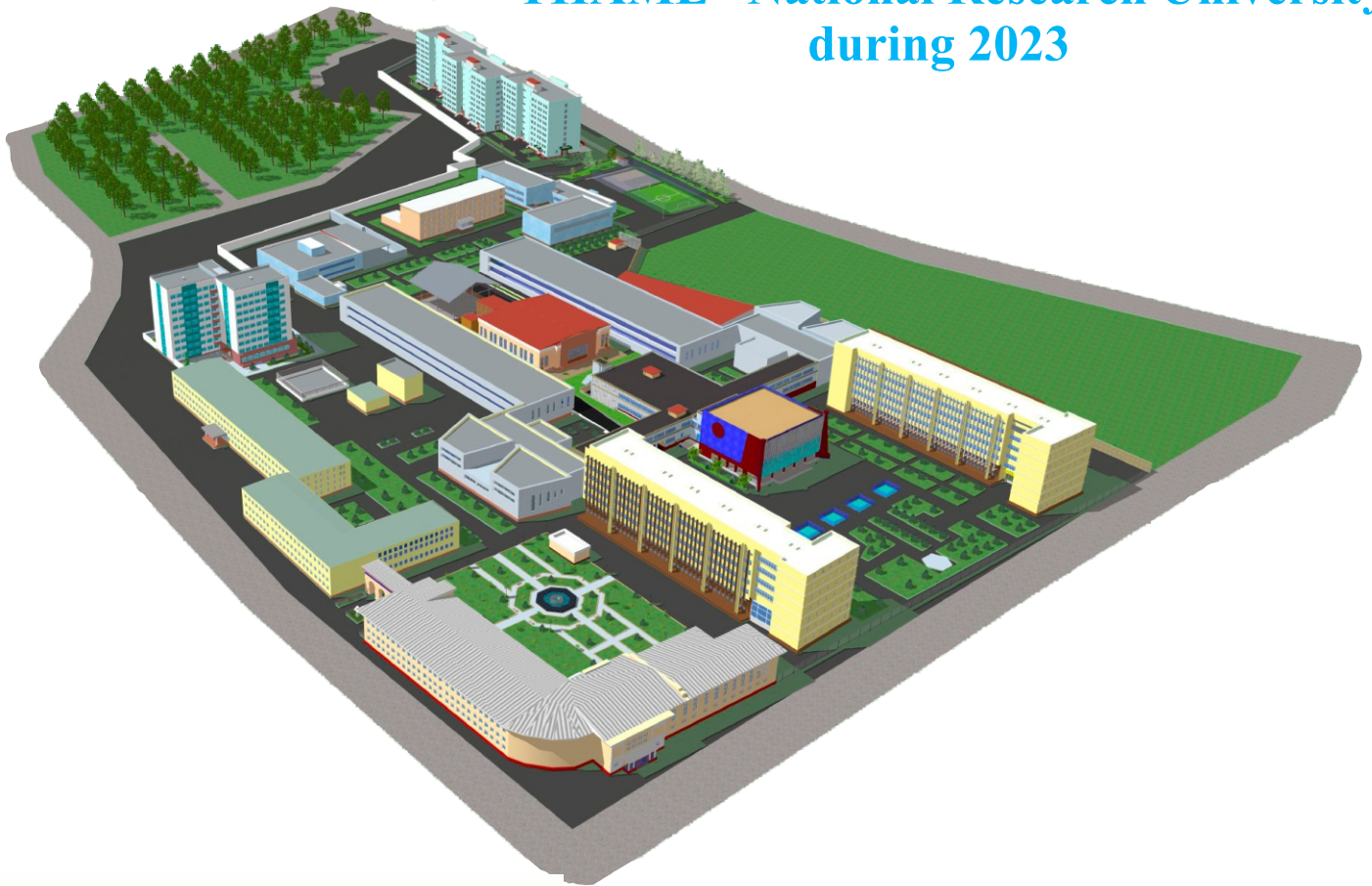

[www.tiame.uz](http://www.tiame.uz)



[facebook.com/tiame.uz](https://www.facebook.com/tiame.uz)



<https://twitter.com/tiameofficial>



[instagram.com/tiameofficial](https://www.instagram.com/tiameofficial)



<https://t.me/ilovetiame>



Scan me

## **ANNUAL REPORT ON THE AMOUNT OF FOOD WASTE IN “TIHAME” NATIONAL RESEARCH UNIVERSITY DURING 2023**

Our institute has 1 closed and 1 open student canteen, 7 cafeterias where you can buy small food products in educational buildings, and 5 9-story student residences. As a result of observations, the amount of food waste generation was studied. According to it, the average food waste for 1 day during the 4 periods of the academic year, i.e. 1st, 2nd, 3rd semesters and summer vacation, is the amount shown in the following tables.

### **The average amount of food waste in 1 day in the 2 semesters of the academic year (January-March) at the institute**

**Table 1**

<b>No</b>	<b>Objects</b>	<b>1 day food waste (kg)</b>
<b>1.</b>	Student kitchen (indoor building)	20
<b>2.</b>	Canteen of professors and teachers	2
<b>3.</b>	Student kitchen (open building)	10
<b>4.</b>	Educational buildings	16
<b>5.</b>	Student residences (9 floors)	22
	<b>Total</b>	<b>70</b>

### **The average amount of food waste per day at the institute in 3 semesters of the academic year (April-June)**

**Table 2**

<b>No</b>	<b>Objects</b>	<b>1 day food waste (kg)</b>
<b>1.</b>	Student kitchen (indoor building)	15
<b>2.</b>	Canteen of professors and teachers	3
<b>3.</b>	Student kitchen (open building)	8
<b>4.</b>	Educational buildings	10
<b>5.</b>	Student residences (9 floors)	20
	<b>Total</b>	<b>56</b>

**The average amount of food waste per day in the summer vacation period of the academic year (July-August) at the institute**

**Table 3**

<b>No</b>	<b>Objects</b>	<b>1 day food waste (kg)</b>
<b>1.</b>	Student kitchen (indoor building)	0
<b>2.</b>	Canteen of professors and teachers	2
<b>3.</b>	Student kitchen (open building)	2
<b>4.</b>	Educational buildings	4
<b>5.</b>	Student residences (9 floors)	0
	<b>Total</b>	<b>8</b>

**The average amount of food waste per day at the institute in the 1st semester of the academic year (September-December)**

**Table 4**

<b>No</b>	<b>Objects</b>	<b>1 day food waste (kg)</b>
<b>1.</b>	Student kitchen (indoor building)	24
<b>2.</b>	Canteen of professors and teachers	5
<b>3.</b>	Student kitchen (open building)	10
<b>4.</b>	Educational buildings	14
<b>5.</b>	Student residences (9 floors)	23
	<b>Total</b>	<b>86</b>

Food waste mainly includes food waste containers, plastic and paper products.

In order to achieve convenient sorting of this type of waste by types, boxes for sorting such waste by types were installed on the territory of our institute.

Our institute currently has a total of 5305 students in the 2022-2023 academic year, and 5216 students in the 2023-2024 academic year, 764 professors and teachers and employees. This quota varies depending on the periods of the year mentioned above. The table below shows the number of people counted per day in the territory of the institute in 2023.



## Estimated daily average number of people at the Institute in 2023

**Table 5**

No	Periods	Number of professors	Employees of the institute	Number of students	The number of guests who visited the Institute in 1 day	Total
1	<b>2 semesters</b> January-March	498	66	5305	60	5929
2	<b>3 semesters</b> April-June	498	66	5305	50	5919
3	<b>Summer vacation</b> July-August	154	22	1000	40	1216
4	<b>1 Semester</b> September-December	498	66	5216	80	5860

From the above two types of data, we can determine that we can see the average amount of food waste generated in the institution per person.

## Estimated average amount of food waste per person at the institution in 2023

**Table 7**

No	Periods	Estimated number of people in the Institute per day	Average amount of food waste per day (kg)	Average amount of food waste per person (kg)
1	<b>2 semesters</b> January-March	5929	70	0.012
2	<b>3 semesters</b> April-June	5919	56	0.008
3	<b>Summervacation</b> July-August	1216	8	0.007
4	<b>1 semester</b> September-December	5860	86	0.015

The analyzed data shows that in our institute during 2023, approximately one person generated 1.6 kg of food waste per year. It was also determined that 12.3 tons of food waste was generated in our institute in 2023.